

EFFECTIVE FROM 01-04-2013

PRICELIST FOR DIES & DIENUTS



Hints On Use Of Circular Dies :

1. Always ensure the die is presented to the bolt squarely, and is concentric, if this is not correct the die will not cut evenly on all lands.
2. When adjusting a split die, try to avoid opening it out excessively, as it tend to rubbing or breakage.
3. When closing in, do not apply all the pressure on one position but keep it even. Dies will cut satisfactorily provided adjustment is kept in the range of approximately 0.4 mm.
4. Thread tearing and teeth chipping are due to incorrect sharpening of lands or due to causing the die to hit the shoulder.
5. Before starting a die always chamfer the end of the bolt at around 45 to allow the die to start cutting gently, failure to do this throws a sudden jerk on to the cutting edge, causing chipping.
6. The size of the bolt to be threaded should be basic size, as an oversize material will put an extra load on the die whilst cutting.
7. whenever dies are used on machine it is recommended to use ground thread dies.
8. when the dies is to be used on machine without lead screw feed, ensure that the die will be able to advance in to the hole freely. This ensure that it will cuts its own correct pitch.
9. Efficient threading using die has it's optimum speed. Always start with lower speeds and increase slowly if work permits.
10. First class threading can only be done with copious supply of proper lubricant. Use of lubricant is as important as it's choice. Choose suitable lubricant.

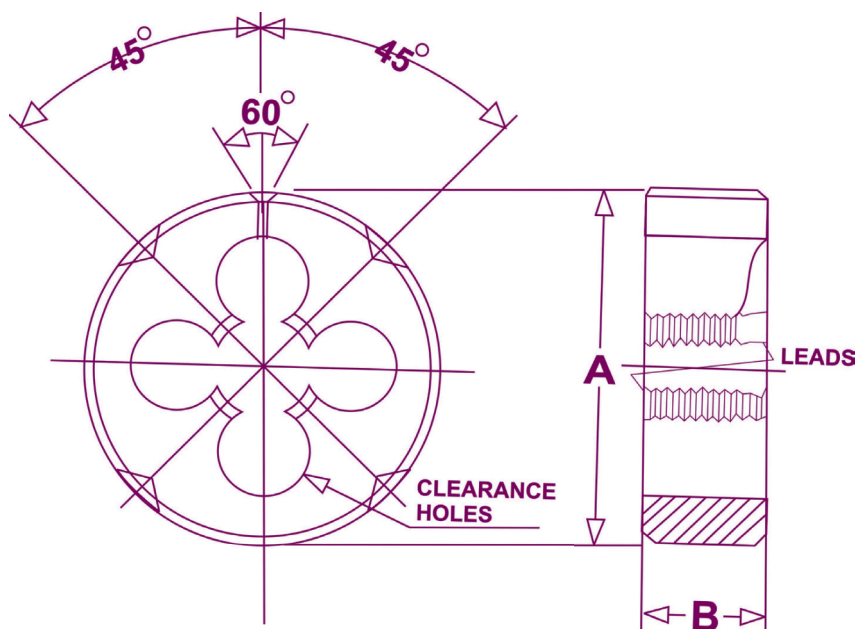

"TOTEM" HIGH SPEED STEEL CUT THREAD CIRCULAR SPLIT DIES

OD INCH	SIZE INCH	BSW each RS.	BSF each RS.	UNF each RS.	UNC each RS.	BSB each RS.	BSCYCLE each RS.	ME each RS.	BSP each RS.	BSCON each RS.	BA each RS.
13/16"	0	-	-	-	-	-	-	-	-	-	284
-	1	-	-	-	-	-	-	-	-	-	284
-	2	-	-	-	-	-	-	-	-	-	284
-	3	-	-	325	325	-	-	-	-	-	284
-	4	-	-	325	325	-	-	-	-	-	284
-	5	-	-	325	325	-	-	-	-	-	284
-	6	-	-	325	325	-	-	-	-	-	284
-	7	-	-	-	-	-	-	-	-	-	325
-	8	-	-	325	325	-	-	-	-	-	325
-	9	-	-	-	-	-	-	-	-	-	419
-	10	-	-	325	325	-	-	-	-	-	419
-	11	-	-	-	-	-	-	-	-	-	419
-	12	-	-	325	325	-	-	-	-	-	-
-	1/16	419	-	-	-	-	-	-	-	-	-
-	3/32	325	-	-	-	-	-	-	-	-	-
-	1/8	284	-	-	-	-	-	284	-	-	-
-	5/32	284	-	-	-	-	-	284	-	-	-
-	3/16	284	284	-	-	-	-	284	-	-	-
-	7/32	284	284	-	-	-	-	284	-	-	-
-	1/4	284	284	284	284	284	-	284	-	284	-
1"	1/8	-	-	-	-	-	-	-	405	-	-
-	1/4	405	405	405	405	405	405	405	-	-	-
-	9/32	405	405	-	-	-	-	405	-	-	-
-	5/16	405	405	405	405	405	405	405	-	-	-
-	3/8	405	405	405	405	405	405	405	-	-	-
-	0.308 x 30	-	-	-	-	-	405	-	-	-	-

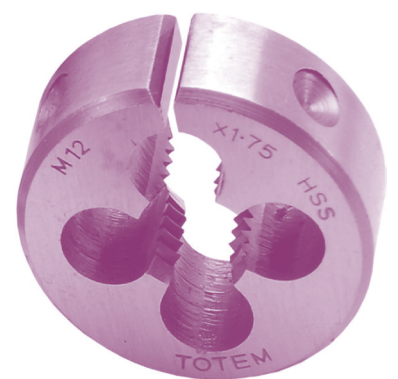

"TOTEM" HIGH SPEED STEEL CUT THREAD CIRCULAR SPLIT DIES

OD INCH	SIZE INCH	BSW each RS.	BSF each RS.	UNF each RS.	UNC each RS.	BSB each RS.	BSCYCLE each RS.	ME each RS.	BSP each RS.	BSCON each RS.	BA each RS.
1.1/2"	1/4	-	-	-	-	-	-	-	674	-	-
-	3/8	-	-	-	-	-	-	-	674	-	-
-	7/16	674	674	674	674	-	-	-	-	-	-
-	1/2	674	674	674	674	-	-	-	674	674	-
-	9/16	674	674	674	674	-	-	-	-	-	-
-	5/8	674	674	674	674	-	-	-	-	674	-
-	11/16	674	-	-	-	-	-	-	-	-	-
-	3/4	674	674	674	674	-	-	-	-	674	-
2"	1/2	-	-	-	-	-	-	-	1074	-	-
-	5/8	-	-	-	-	-	-	-	1074	-	-
-	3/4	-	-	-	-	-	-	-	1074	-	-
-	7/8	1074	1074	1074	1074	-	-	-	1074	-	-
-	1"	1074	1074	1074	1074	-	-	-	1074	-	-
2.1/4"	7/8	-	-	-	-	-	-	-	1356	-	-
-	1.1/8	1356	1356	1356	1356	-	-	-	-	-	-
-	1.1/4	1356	1356	1356	1356	-	-	-	-	-	-
2.1/2"	1.1/8	-	-	-	-	-	-	-	2134	-	-
-	1.1/4	2134	-	-	-	-	-	-	2134	-	-
-	1.3/8	2134	2134	2134	2134	-	-	-	-	-	-
-	1.1/2	2134	2134	2134	2134	-	-	-	-	-	-
3"	1.1/4	-	-	-	-	-	-	-	3012	-	-
-	1.1/2	3012	3012	3012	3012	-	-	-	-	3012	-
4"	1.3/8	-	-	-	-	-	-	-	4204	-	-
-	1.1/2	-	-	-	-	-	-	-	4204	-	-
-	1.3/4	4204	4204	4204	4204	-	-	-	4204	-	-
-	2"	4204	4204	4204	4204	-	-	-	4204	-	-

MOQ Matrix

OD	QTY
2.1/4"	5
2.1/2"	5
3"	3
4"	3

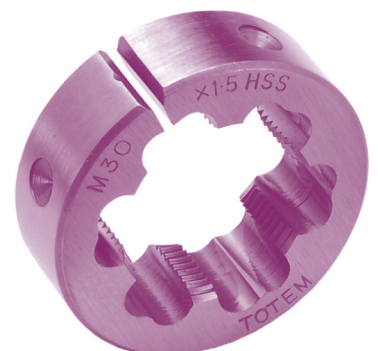

"TOTEM" HIGH SPEED STEEL CUT THREAD CIRCULAR SPLIT DIES

OD INCH	SIZE MM	EACH RS.	OD INCH	SIZE MM	EACH RS.	OD INCH	SIZE MM	EACH RS.
13/16"	1.6 X 0.35	419	1"	6 X 0.5, 0.75	433	1.1/2"	11X 1.0, 1.5	674
-	2 X 0.4	325	-	6 X 1	405	-	12 X 1, 1.25, 1.5, 1.75	674
-	2.2 X 0.45	325	-	7 X 0.75	433	-	14 X 1, 1.25, 1.5, 2	674
-	2.3 X 0.4	325	-	7 X 1	405	-	15 X 1.5	674
-	2.5 X 0.45	325	-	8 X 0.75, 1	433	-	16 X 1, 1.5, 2.0	674
-	2.6 X 0.45	325	-	8 X 1.25	405	-	18 X 1.5, 2.5	674
-	3 X 0.35, 0.60	325	-	9 X 0.75,1	433	-	20 X 1.5, 2.5	674
-	3 X 0.5	284	-	9 X 1.25	405	-	-	-
-	3.5 X 0.6	284	-	10X0.5,0.75,1,1.25	433	-	-	-
-	4 X 0.35, 0.50	325	-	10 X 1.5	405	-	-	-
-	4 X 0.7	284	-	-	-	-	-	-
-	4 X 0.75	325	-	-	-	-	-	-
-	4.5 X 50	325	-	-	-	-	-	-
-	4.5X0.75	325	-	-	-	-	-	-
-	5 X 0.8	284	-	-	-	-	-	-
-	5X0.9	325	-	-	-	-	-	-
-	5.5 X 0.75	325	-	-	-	-	-	-
-	5.5 X 0.5, 0.9	325	-	-	-	-	-	-
-	6 X 0.5, 0.75	325	-	-	-	-	-	-
-	6X1	284	-	-	-	-	-	-
-	7 X 0.75	325	-	-	-	-	-	-
-	7X1	325	-	-	-	-	-	-
2"	22 X 1.5	1074	2.1/4"	27X3.0	1356	2.1/2"	34x1.5	2134
-	22 X 2.5	1074	-	30X3.5	1356	-	35x1.5	2134
-	24 X 1, 1.5, 3	1074	-	32x1.5	1356	-	36x1.5, 4.0	2134
-	25 x 1.5	1074	-	33 x 1.5, 3.5	1356	-	40 x 1.5	2134
-	26 x 1.5	1074	-	-	-	-	-	-
-	27 x 1.5, 3.0	1074	-	-	-	-	-	-
-	28 x 1.5	1074	-	-	-	-	-	-
-	30 x 1.5, 3.5	1074	-	-	-	-	-	-
3"	34 x 1.5	3012	4"	45 x 1.5	4204	-	-	-
-	35 x 1.5	3012	-	46 x 1.5	4204	-	-	-
-	36 x 1.5, 4.0	3012	-	48 x 1.5, 5.0	4204	-	-	-
-	38 x 1.5	3012	-	50 x 1.5	4204	-	-	-
-	39 x 4	3012	-	52 x 1.5	4204	-	-	-
-	42 x 4.5	3012	-	55 x 1.5	4204	-	-	-
-	45 x 1.5	3012	-	60 x 1.5	4204	-	-	-

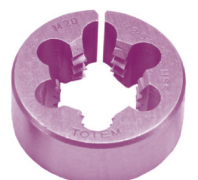

"TOTEM" CARBON STEEL CUT THREAD CIRCULAR SPLIT DIES

OD INCH	SIZE INCH	BSW each RS.	BSF each RS.	UNF each RS.	UNC each RS.	BSB each RS.	BSCYCLE each RS.	ME each RS.	BSP each RS.	BSCON each RS.	BA each RS.	WF each Rs.
13/16"	0	-	-	-	-	-	-	-	-	-	78	-
-	1	-	-	-	-	-	-	-	-	-	78	-
-	2	-	-	-	-	-	-	-	-	-	78	-
-	3	-	-	78	78	-	-	-	-	-	78	-
-	4	-	-	78	78	-	-	-	-	-	78	-
-	5	-	-	78	78	-	-	-	-	-	78	-
-	6	-	-	78	78	-	-	-	-	-	78	-
-	7	-	-	-	-	-	-	-	-	-	113	-
-	8	-	-	78	78	-	-	-	-	-	113	-
-	9	-	-	-	-	-	-	-	-	-	134	-
-	10	-	-	78	78	-	-	-	-	-	134	-
-	11	-	-	-	-	-	-	-	-	-	191	-
-	12	-	-	78	78	-	-	-	-	-	191	-
-	11/71 x 40, 48	-	-	-	-	-	-	-	-	-	-	78
-	13/71 x 24, 36	-	-	-	-	-	-	-	-	-	-	78
-	3/16 x 28	-	-	-	-	-	-	-	-	-	-	78
-	15/71 x 28, 40	-	-	-	-	-	-	-	-	-	-	78
-	1/4x32	-	-	-	-	-	-	-	-	-	-	-
-	1/16	191	-	-	-	-	-	-	-	-	-	-
-	3/32	113	-	-	-	-	-	-	-	-	-	-
-	1/8	78	-	-	-	-	-	78	-	-	-	-
-	5/32	78	-	-	-	-	-	78	-	-	-	-
-	3/16	78	78	-	-	-	78	78	-	-	-	-
-	7/32	78	78	-	-	-	-	78	-	-	-	-
-	1/4	78	78	78	78	78	78	78	-	-	-	-
1"	5/16 x 30, 40	-	-	-	-	-	-	-	-	-	-	123
-	3/8 x 40	-	-	-	-	-	-	-	-	-	-	123
-	1/8	-	-	-	-	-	-	-	123	-	-	-
-	1/4	123	123	123	123	-	-	123	-	-	-	-
-	9/32	123	123	-	-	-	-	123	-	-	-	-
-	5/16	123	123	123	123	-	-	123	-	-	-	-
-	3/8	123	123	123	123	-	-	123	-	-	-	-
-	0.308 x 30	-	-	-	-	-	123	-	-	-	-	-

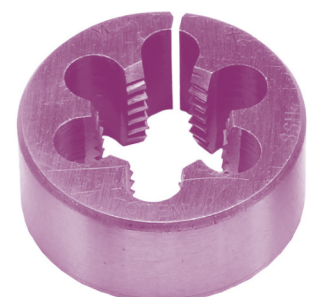

"TOTEM" CARBON STEEL CUT THREAD CIRCULAR SPLIT DIES

OD INCH	SIZE INCH	BSW each RS.	BSF each RS.	UNF each RS.	UNC each RS.	BSB each RS.	BSCYCLE each RS.	ME each RS.	BSP each RS.	BSCON each RS.	BA each RS.	WF each RS.
1.1/2"	7/16 x 32, 40	-	-	-	-	-	-	-	-	-	-	261
-	1/2/32 x40	-	-	-	-	-	-	-	-	-	-	261
-	1/4	-	-	-	-	-	-	-	261	-	-	-
-	3/8	-	-	-	-	-	-	-	261	-	-	-
-	7/16	261	261	261	261	-	-	-	-	-	-	-
-	1/2	261	261	261	261	-	-	-	261	261	-	-
-	9/16	261	261	261	261	261	261	-	-	-	-	-
-	5/8	261	261	261	261	-	-	-	-	261	-	-
-	11/16	261	261	-	-	-	-	-	-	-	-	-
-	3/4	261	261	261	261	-	-	-	-	261	-	-
2"	1/2	-	-	-	-	-	-	-	399	-	-	-
-	5/8	-	-	-	-	-	-	-	399	-	-	-
-	3/4	-	-	-	-	-	-	-	399	-	-	-
-	7/8	399	399	399	399	-	-	-	399	-	-	-
-	1"	399	399	399	399	-	-	-	399	399	-	-
2.1/4"	7/8	-	-	-	-	-	-	-	772	-	-	-
-	1.1/8	772	772	772	772	-	-	-	-	-	-	-
-	1.1/4	772	772	772	772	-	-	-	-	-	-	-
2.1/2"	1.1/8	-	-	-	-	-	-	-	1091	-	-	-
-	1.1/4	-	-	-	-	-	-	-	1091	-	-	-
-	1.3/8	1091	1091	1091	1091	-	-	-	-	-	-	-
-	1.1/2	1091	1091	1091	1091	-	-	-	-	-	-	-
3"	1.1/4	-	-	-	-	-	-	-	1230	1230	-	-
-	1.1/2	1230	1230	1230	1230	-	-	-	-	-	-	-
4"	1.3/8	-	-	-	-	-	-	-	1807	-	-	-
-	1.1/2	-	-	-	-	-	-	-	1807	-	-	-
-	1.3/4	1807	1807	1807	1807	-	-	-	1807	-	-	-
-	2"	1807	1807	1807	1807	-	-	-	1807	-	-	-

MOQ Matrix

OD	QTY
2.1/4"	5
2.1/2"	5
3"	3
4"	3

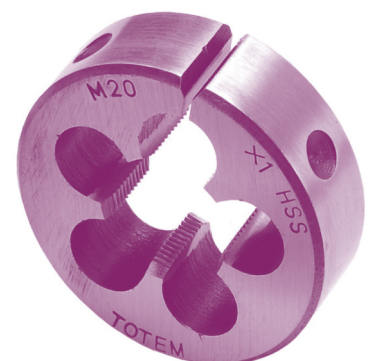

"TOTEM" CARBON STEEL CUT THREAD CIRCULAR SPLIT DIES

OD INCH	SIZE MM	EACH RS.	OD INCH	SIZE MM	EACH RS.	OD INCH	SIZE MM	EACH RS.
13/16"	1.6 x 0.35	191	1"	6 x 0.5, 0.75	123	1.1/2"	11x 1.0,1.5	261
-	2 x 0.4	113	-	6 x 1	123	-	12 x 1, 1.25, 1.5,1.75	261
-	2.2 x 0.45	113	-	7 x 0.75	123	-	14x1,1.25,1.5	261
-	2.3x0.4	113	-	7x1	123	-	14x2	261
-	2.5x0.45	113	-	8x0.75, 1.0	123	-	15x 1.0,1.5	261
-	2.6 x 0.45	113	-	8 x 1.25	123	-	16 x 1.0,1.5	261
-	3x0.5	78	-	9x0.75, 1.0	123	-	16x2	261
-	3.5 x 0.6	78	-	9 x 1.25	123	-	18 x 1.0, 1.5, 2.0, 2.5	261
-	4 x 0.75	78	-	10 x 0.75, 1,1.25	123	-	20 x 1.5, 2.5	261
-	4x0.7	78	-	10x1.50	123	-	-	-
-	4.5x0.5	78	-	-	-	-	-	-
-	4.5 x 0.75	78	-	-	-	-	-	-
-	5 x 0.5, 0.75, 0.90	78	-	-	-	-	-	-
-	5x8	78	-	-	-	-	-	-
-	5.5 x 0.5, 0.90	78	-	-	-	-	-	-
-	6 x 0.5, 0.75	78	-	-	-	-	-	-
-	6x1	78	-	-	-	-	-	-
-	7 x 0.75	78	-	-	-	-	-	-
-	7 x 1	78	-	-	-	-	-	-
2"	20 x 1.5, 2.5	399	2.1/4"	27 x 3.0	772	2.1/2"	34 x 1.5	1091
-	22 x 1.5, 2.5	399	-	30 x 3.5	772	-	35 x 1.5	1091
-	24 x 1.5	399	-	32 x 1.5	772	-	36 x 1.5, 4.0	1091
-	24 x 3	399	-	33 x 1.5, 3.5	772	-	40 x 1.5	1091
-	25 x 1.5	399	-	-	-	-	-	-
-	26 x 1.5	399	-	-	-	-	-	-
-	27 x 1.5, 3.0	399	-	-	-	-	-	-
-	28 x 1.5	399	-	-	-	-	-	-
-	30 x 1.5, 3.5	399	-	-	-	-	-	-
3"	34 x 1.5	1230	4"	45 x 1.5	1807	-	-	-
-	35 x 1.5	1230	-	46 x 1.5	1807	-	-	-
-	36 x 1.5, 4.0	1230	-	48 x 1.5, 5.0	1807	-	-	-
-	38 x 1.5	1230	-	50 x 1.5	1807	-	-	-
-	39 x 4	1230	-	52 x 1.5	1807	-	-	-
-	42 x 4.5	1230	-	55 x 1.5	1807	-	-	-
-	45 x 1.5	1230	-	60 x 1.5	1807	-	-	-

MOQ Matrix

OD	QTY
2.1/4"	5
2.1/2"	5
3"	3
4"	3



"TOTEM NPT / BSPT ROUND DIES"

HIGH SPEED STEEL

SIZE	INCH	OD INCH					
		1"	1.1/2"	2"	2.1/2"	3"	4"
-		Each Rs	Each Rs	Each Rs	Each Rs	Each Rs	Each Rs
1/8"		514	640	-	-	-	-
1/4"		-	715	-	-	-	-
3/8"		-	840	1029	-	-	-
1/2"		-	-	1167	-	-	-
3/4"		-	-	1431	2535	-	-
1"		-	-	-	2861	3326	-
1.1/4"		-	-	-	-	3890	4643
1.1/2"		-	-	-	-	-	4996
2"		-	-	-	-	-	-

CARBON STEEL

SIZE	INCH	OD INCH					
		1"	1.1/2"	2"	2.1/2"	3"	4"
-		Each Rs	Each Rs	Each Rs	Each Rs	Each Rs	Each Rs
1/8"		326	415	-	-	-	-
1/4"		-	527	-	-	-	-
3/8"		-	552	715	-	-	-
1/2"		-	-	791	-	-	-
3/4"		-	-	1029	1306	-	-
1"		-	-	-	1443	1607	-
1.1/4"		-	-	-	-	1933	-
1.1/2"		-	-	-	-	-	2334
2"		-	-	-	-	-	2761

MOQ Matrix

OD	QTY
1"	10
1.1/2"	10
2"	5
2.1/2"	5
3"	3
4"	3



"TOTEM" HIGH SPEED STEEL DIES NUTS

ACROSS FLAT	BSW/BSF/UNC/UNF	BSP	METRIC MM	Each Rs HIGH SPEED STEEL
0.710	1 /8 to 1 /4	-	3 to 6	264
0.820	5/16'	-	7 to 8	314
0.920	3/8'	1/8'	9 to 10	338
1.010	7/16'	-	11	464
1.100	1/2'	1/4'	12 to 13	514
1.300	9/16, 5/8	3/8'	14 to 16	652
1.480	11/16,3/4	-	18 to 20	777
1.670	7/8'	1/2',5/8	21 to 22	1054
2.050	1'	3/4'	24 to 26	1632

"TOTEM" CARBON STEEL DIES NUTS

ACROSS FLAT	BSW/BSF/UNC/UNF	BSP	METRIC MM	Each Rs CARBON STEEL
0.710	1 /8 to 1 /4	-	3 to 6	101
0.820	5/16'	-	7 to 8	107
0.920	3/8'	1/8'	9 to 10	119
1.010	7/16'	-	11	226
1.100	1/2'	1/4'	12 to 13	289
1.300	9/16, 5/8	3/8'	14 to 16	314
1.480	11/16, 3/4	-	18 to 20	351
1.670	7/8'	1/2',5/8	21 to 22	464
2.050	1'	3/4'	24 to 26	628

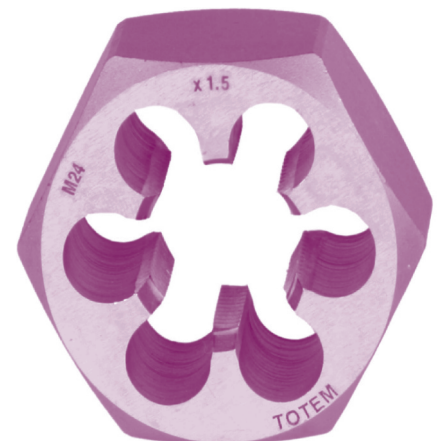

"TOTEM" HIGH SPEED STEEL GROUND THREAD DIES

OD x THICKNESS	SIZE	EACH RS.	OD x THICKNESS	SIZE	EACH RS.
16 x 5	1.6 x 0.35	763	30 x 11	10.0 x 1.00	791
-	-	-	-	10.0 x 1.25	791
20x5	1.6x0.35	763	-	10.0x1.50	791
-	2.0 x 0.40	590	-	-	-
-	2.5 x 0.45	590	38 x 10	12.0 x 1.00	1217
-	2.6 x 0.45	590	-	12.0 x 1.25	1217
-	3.0x0.50	514	-	12.0x1.5	1217
-	4.0 x 0.70	514	-	14.0 x 1.00	1217
-	-	-	-	14.0 x 1.25	1217
20 x 7	5.0 x 0.80	514	-	14.0 x 1.5	1217
-	6.0 x 1.00	514	-	-	-
-	-	-	38x14	12.0x1.75	1217
25 x 9	7.0 x 1.00	753	-	14.0 x 2.00	1217
-	8.0 x 1.00	791	-	-	-
-	8.0 x 1.25	753	-	-	-

- All dies are in M2 steel, we can quote for M35 steel on special request.
- For Gun more die, add 35% extra

OD X Thickness	No.QTY
16X5	20
20X5	20
20X7	20
25X9	10
30X11	10
38X10	10
38X14	10

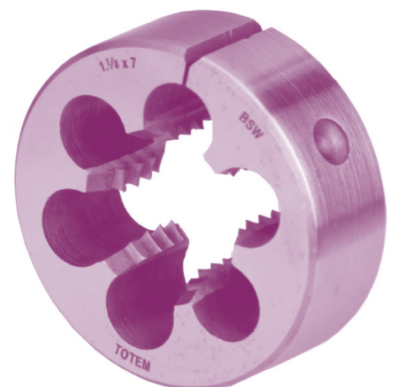

GENERAL TERMS & CONDITIONS FOR SUPPLY :

1. Prices are inclusive of excise duty at current rate.
2. Sales tax, Octroi & other govt.levies will be charged extra as applicable.
3. Prices are subject to revision without prior notice.
4. This price list supercedes all our previous price lists.
5. All legal proceedings are subjected to mumbai jurisdiction.

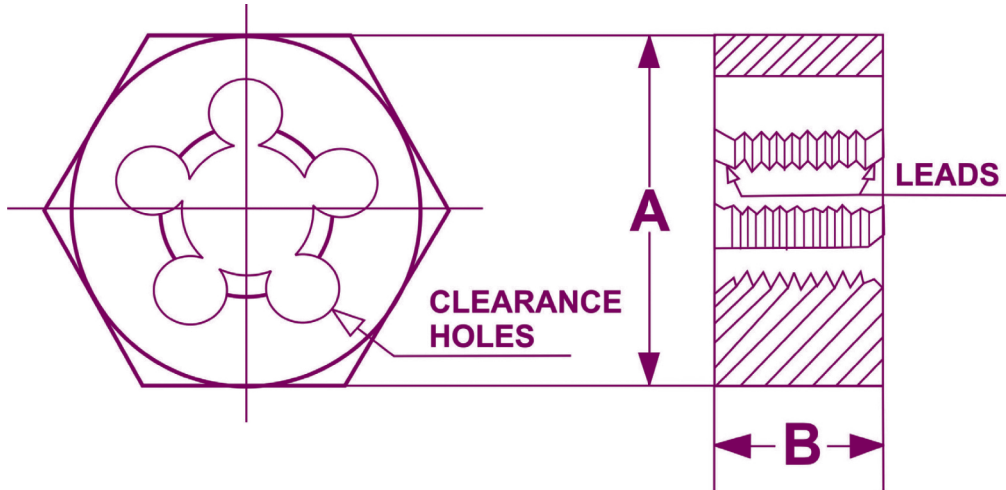

FORBES

FORBES & COMPANY LIMITED

WORKS

: Saki Powai Road, Chandivali, Mumbai - 400 072. Tel: 28471861/2847 1298. Fax: 2847 1799/28473191, E-mail.:mumbai@forbes.co.in.
E-mail.: sales@forbes.co.in
: A7 MIDC Area Chikalhana, Aurangabad - 431 210. Tel. : 2485 226/ 27 / 2485 044. Fax.: 2485 058

DIVISIONAL SALES OFFICES ADDRESS / PH. NO. / FAX

www.totem-forbes.com

Ahmedabad	: Pran Vijay, 1st Floor, Ashram Road, Ahmedabad- 380009. Tel: 079-26587769 Fax: 079-26580741.
*Baroda	: 12/190 M. I. G. Flats Karelilbag, Baroda-390018 (M) 09825917524.
Bangalore	: No. 24, 3rd Floor, Classic Building, Richmond Road, Bengaluru- 560025. Tel: 080- 43230130 Fax:080-43230140
Chennai	: 108, Catholic Centre, 1st Floor, Armenian Street, Chennai- 600001. Tel: 044-25389890/95 Fax: 044-25360872.
*Chandigarh	: House No. 527, Sector 11B, Chandigarh. (M)09417028106.
Kolkata	: Royal Insurance Bldg., Gr.Floor, 5 & 7, Netaji Subhash Road, Kolkata- 700001. Tel: 033-22622946, Fax: 033-22622947.
Mumbai	: Saki Powai Road, Chandivali, Mumbai-400072. Tel: 022-28471861, Fax: 022-28473191.
New Delhi	: 9/10-3, Asaf Ali Road, New Delhi-110002. Tel: 011-43000120/9 Fax: 011-43000130.
Pune	: H.No. 1195/5, 4th floor, Bhosale Heights, opp. Deendayal Hospital, Fergusson College Road, Pune-411 005. Tel: 020-41359 111/101.
*Rajkot	: 402, Nandanvan Apt.,Nandanvan Soc.,Nr.Raiya chokdi,Rajkot 360007 (M) 09638890890.
*Secundrabad	: 5th Floor, P.V.S Mansion,Somasundaram Street, Beside Manju Theatre,S,D Road, Secunderabad-500003. Mob. 9652004949

*Residential Representatives